

compact

TKM 900 SRW

EAC & CE
CERTIFICATE



SPARE PART
SUPPORT



%70 POWER
ECONOMY



24 MONTHS
GUARANTEE



RENEWABLE
MACHINE



HIGH
SAFETY

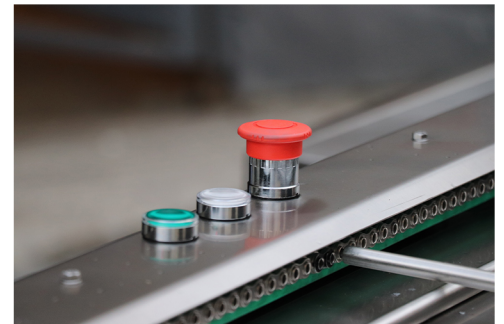

TKM 900 SRW

Completely made of stainless steel. The mold and aluminum parts are eloxal coated. Values can be monitored numerically and graphically with the touch operator panel and any action can be done easily. The pneumatic system is controlled by sensors on the machine and operator is directed by warning message on display. The machine has printed film, non-printed film options and photocell system. Easy to replace mold system provides low mold cost effectiveness, unlimited mold choice and high performance.

compact

TKM 900 SRW

Technical Specifications

INSTALLED POWER	400v 50 Hz 40 A R.S.T.N.PE
ENERGY CONSUMPTION	1.8 KW
AIR PRESSURE	MAX. 6 BAR
AIR CONSUMPTION	4.5 LT CYCLE
CAPACITY/MIN	10-16 PROCESS
MACHINE DIMENSIONS	2410X1245X1820+500MM
MAX. MOLD DIMENSIONS	670X310 MM STANDART
WEIGHT NET/PACKAGED	450 KG
MAX. PLATE DEPTH	120 MM
MAX. FILM WIDTH	650 MM
MIN. FILM THICKNESS	40 MIC
INFEEED BELD	1500 MM
DISCHARGE BAND	300 MM
MAXIMUM FILM WEIGHT	16 KG

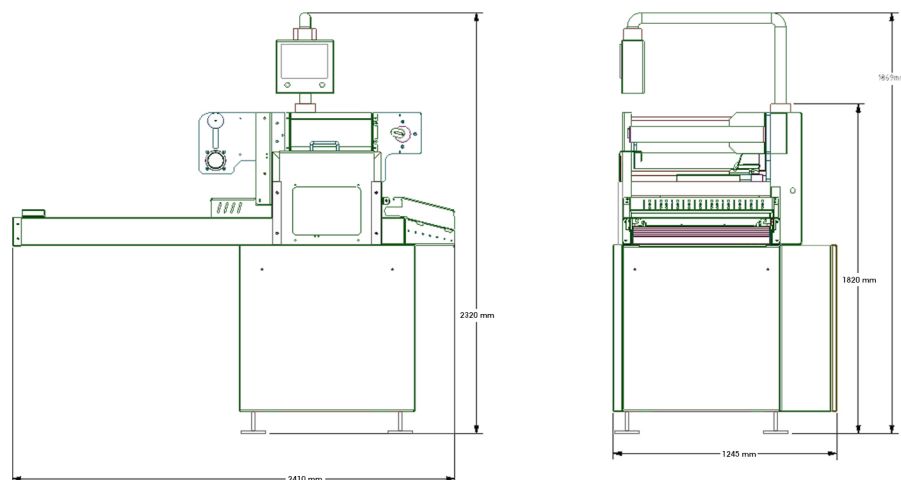
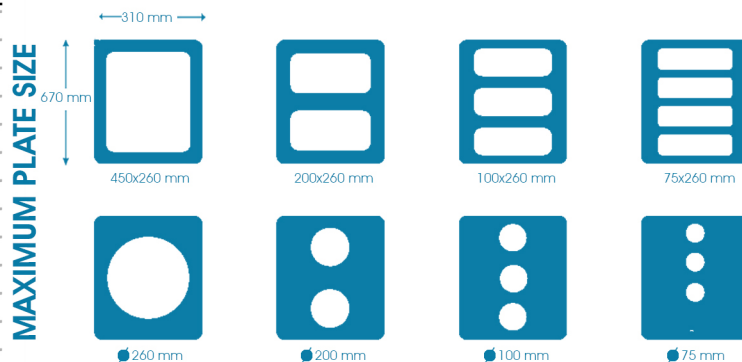

TKM 900 SRW Advantages

Line type solution on without vacuum tray sealing	Automatic-manual and by step by step options	7 inch Touch screen operator panell	Automatic filling and magazine can be integrated into feed band
Precise positioning with servo control loading band	Values are monitored numerically and graphically	Possibility of only welding and cutting by one-touch	Photocell unit to use printed film
Eloxal coated aluminum parts	Energy saving with automatic temperature control system (PID)	Stainless steel body of quality 304	Teflon-coated mold system
Very easy to transport by stainless steel wheels	Automatic film adjustment and waste film discharge system	Completely cuts the film around the plate and does not need extra labor	Easy to clean and hygienic equipment